

# AC3 HD-SDI PTZ Camera

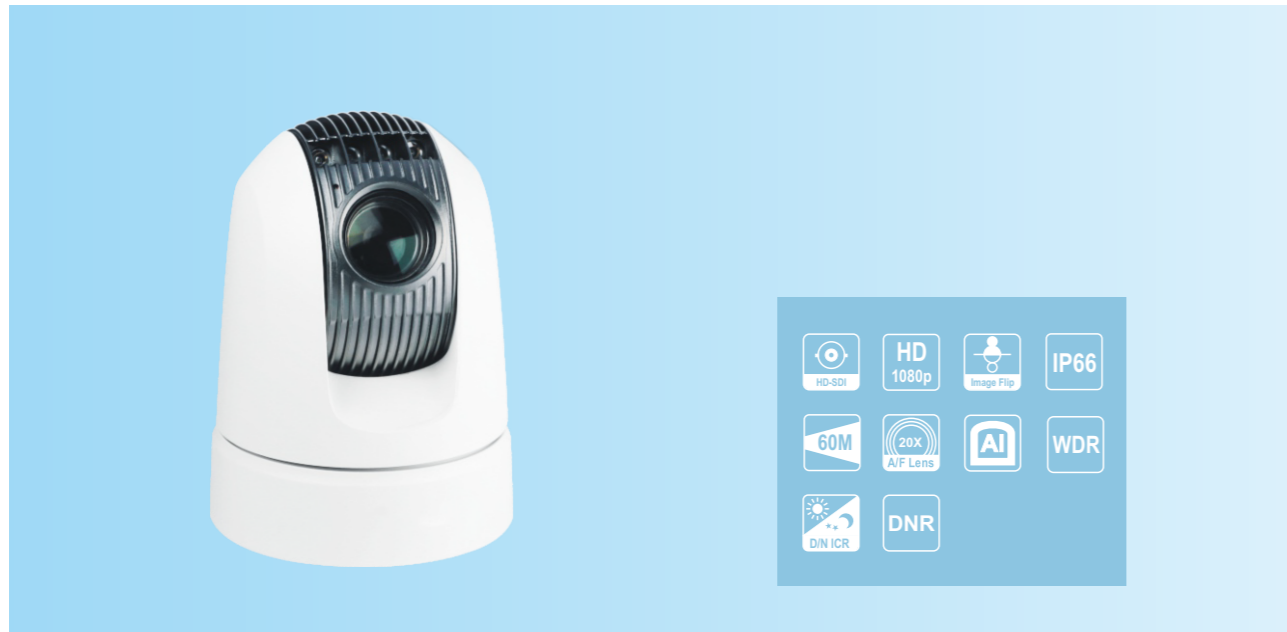

## Features

- 1/2.8" CMOS, 2.14MP, 20X optical zoom;
- Supports HD-SDI and Analog output;
- Efficient 60m IR distance;
- Wide dynamic range, ICR day/night;
- Digital image stabilization;
- Protection index: IP66;
- Soft PTZ address, protocol and baud rate self-adaptive;
- 10.8~28V voltage input;
- Auto power-off with low power supply.

## Dimensions

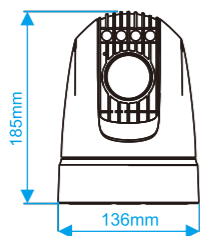

Front View

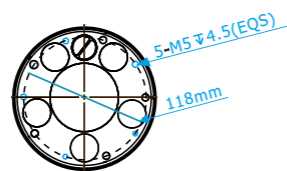

Bottom View

## Technical Data

| Model Camera            |  |
|-------------------------|--|
| Image Sensor            | 1/2.8" Progressive Scan CMOS, 2.14MP                                       |
| Active Pixel            | 1920(H) x 1080(V)  |
| Signal System (HD)      | 1080P/30, 1080P/25, 1080I/60, 1080I/50, 720P/60, 720P/50, 720P/30, 720P/25 |
| Signal System (SD)      | PAL / NTSC   |
| Min Illumination        | Color: 0.5Lux; B/W: 0.1Lux   |
| WB                      | Auto   |
| Focus                   | Auto / Manual  |
| Exposure Control        | Auto / Manual  |
| S/N Ratio               | Not less than 50DB   |
| BLC                     | On / Off   |
| WDR                     | On / Off   |
| Digital Noise Reduction | 1~5 Steps / OFF  |
| D/N ICR                 | Auto / Manual  |
| Lens                    |  |
| Optical Zoom            | 20X  |
| Digital Zoom            | 12X  |
| Focal                   | f=4.7mm ~ 94mm   |
| IRIS                    | F1.6 ~ F3.5  |
| View Angle              | 59.5° (H) ~ 2.9° (V)   |
| PTZ                     |  |
| Pan Range               | 360° Continuous  |
| Pan Speed               | Control Speed: 0.1° ~ 60°/s, adjustable; Preset Speed: 60°/s               |
| Tilt Range              | -15° ~ 90° (Auto Flip)   |
| Tilt Speed              | Control Speed: 0.2° ~ 60°/s, adjustable; Preset Speed: 60°/s               |
| Preset No               | 256  |
| Preset Precision        | ±0.2°  |
| IR Light                |  |
| IR Wave Length          | 850nm  |
| Range                   | 60m  |
| Switch                  | Auto / Manual  |
| General                 |  |
| Menu Language           | English  |
| Video Output (HD)       | HD-SDI   |
| Video Output (SD)       | CVBS   |
| Comm Interface          | RS-485   |
| Address                 | 0 ~ 255  |
| Comm Protocol           | PELCO-P / PELCO-D (Self-Adaptive)  |
| Baud Rate               | 2400bps, 4800bps, 9600bps, 19200bps (Self-Adaptive)                        |
| Voltage                 | DC10.8 ~ 28V   |
| Power                   | Min: 9W; Max: 20W  |
| Working Temperature     | -25°C ~ +65°C  |
| IP Index                | IP66   |
| Dimension               | Φ136(mm)×185(mm)   |
| Weight                  | 2.1Kg  |